

Strainer 800 lbs Y-type, with bw-ends and drain-plug in cover



Materials: Body: ASTM A 105, Screen: stainless steel AISI 316, Gasket: graphite reinforced

Connection: butt-weld-ends ANSI

Test pressure: 205 bar

DN	L	A	Mesh-width*	Weight (kg)	Article No.**
1/2"	150	105	0,80	1,00	0206525301200
3/4"	150	105	0,80	1,20	0206525303400
1"	150	105	0,80	2,00	0206525304400
1 1/4"	160	145	0,80	6,00	0206525305400
1 1/2"	160	145	0,80	6,00	0206525306400
2"	160	145	0,80	7,00	0206525308400

* Fine screens at all nominal diameters mesh width 0,25 mm, free area 37%

** When ordering with fine screen: Article-Nr. + addition "with F-SIEB"

DN	L1	D1	Fo	KVS1	KVS2	Zet1	Zet2	ø G	ø R	P	D	B
1/2"	41	18	38%	5,1	5,0	1,56	1,60	36	28,5	3,5	1/4"	190
3/4"	60	22	38%	9,7	9,6	2,22	2,27	41	32,5	3,5	1/4"	190
1"	75	28	38%	14,6	13,3	3,07	3,71	50	40,5	3,5	1/4"	190
1 1/4"	100,5	41,5	38%	32,6	29,9	3,84	4,52	70	57	3,5	1/4"	205
1 1/2"	100,5	41,5	38%	32,6	29,9	3,84	4,52	70	57	3,5	1/4"	205
2"	100,5	49,5	38%	50,3	49,8	3,84	3,92	63	52,5	3,5	1/4"	205

The delivery of the strainer is in accordance to PED 2014/68/EU Point 11 and 12 of the preamble and article 1, clause c as well as article 4, clause 3.

The picture shown is only a symbolic photo! Subject to technical changes and errors.

Key for our datasheets

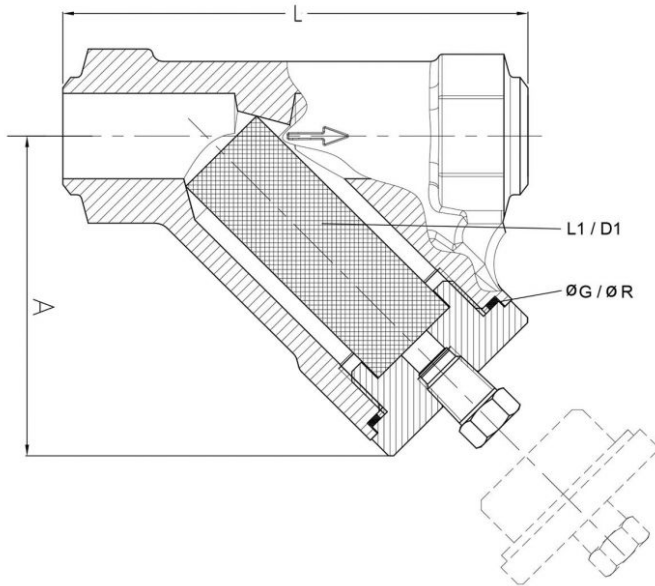

DN	Nominal diameter
L	Face to face dimension (mm)
A	Centre line of pipe to end of cover (mm)
L1	Screen length (mm)
D1	Screen diameter (mm)
Fo	Free screen area standard element (mm)
KVS1	KVS-Value standardscreen (m ³ /h)
KVS2	KVS-Value fine screen (m ³ /h)
Zet1	Zeta-Value standardscreen
Zet2	Zeta-Value fine screen
ø G	Outer-diameter coverflange gasket (mm)
ø R	Inner-diameter coverflange gasket (mm)
P	Thickness coverflange gasket (mm)
D	Coverflange size
B	Distance required to remove screen (mm)