

# Strainer PN 25 Y-type, with flanged ends and drain-plug 1/2" in cover



- Materials:** Body: nodular cast iron JS 1030, Screen: stainless steel 1.4301 (from DN 150 perforated plate 1.4301), Gasket: graphit reinforced
- Connection:** flanged ends DIN
- Test pressure:** 37,5 bar
- Specials:** in- and outside coated by electro-static process RAL 5005 blue - 250µ.

DN	L	A	Mesh-width*	Weight (kg)	Article No.**
15	130	75	0,50	2,00	9690152504
20	150	75	0,50	2,00	9690202504
25	160	90	0,75	3,00	9690252504
32	180	90	0,75	4,00	9690322504
40	200	110	0,75	5,90	9690402504
50	230	120	0,75	6,00	9690502504
65	290	140	0,75	9,60	9690652504
80	310	165	1,20	14,00	9690802504
100	350	220	1,20	22,00	9691002504
125	400	260	1,20	34,00	9691252504
150	480	300	1,20	48,50	9691502504
200	600	360	1,20	111,00	9692002504
250	730	550	1,20	220,00	9692502504
300	850	610	1,20	272,00	9693002504

\* Fine screens at all nominal diameters mesh width 0,25 mm, free area 37%

\*\* When ordering with fine screen: Article-Nr. + addition "with F-SIEB"

DN	L1	D1	Fo	KVS1	KVS2	Zet1	Zet2	ø G	ø R	P	D	B
15	53	25	39 %	5,60	5,50	2,58	2,68	49	40	1,0	70x70	115
20	53	25	39 %	10,70	10,30	2,24	2,41	49	40	1,0	70x70	115
25	66	31	38 %	17,60	16,26	2,02	2,6	55	46	1,0	75x75	135
32	71	38	38 %	29,15	26,60	1,97	2,37	55	46	1,0	75x75	135
40	91	47	38 %	46,10	41,80	1,93	2,34	67	56	1,0	90x90	170
50	105	57	38 %	71,60	63,70	1,95	2,46	74	66	1,0	98x98	190
65	123	73	38 %	119,50	105,40	2,00	2,57	94	83	1,0	111x111	220
80	144	88	36 %	173,50	144,00	2,18	3,16	109	100	1,0	136x136	265
100	184	108	36 %	217,50	196,70	3,38	4,14	134	120	1,0	ø 194	340
125	219	135	36 %	364,40	320,00	2,94	3,81	158	138	1,5	ø 234	410
150	258,5	160	36 %	537,00	468,00	2,81	3,70	180	162	1,5	ø 264	475
200	360	208	36 %	820,00	769,00	3,81	4,33	240	209	2,0	ø 290	580
250	336	231	35 %	1260,00	1108,00	3,94	5,09	319	275	2,0	ø 345	830
300	386	281,5	35 %	1735,00	1520,00	4,31	5,61	379	320	2,0	ø 401	950

The delivery of the strainer is in accordance to PED 2014/68/EU Point 11 and 12 of the preamble and article 1, clause c as well as article 4, clause 3.

The picture shown is only a symbolic photo! Subject to technical changes and errors.

## Key for our datasheets

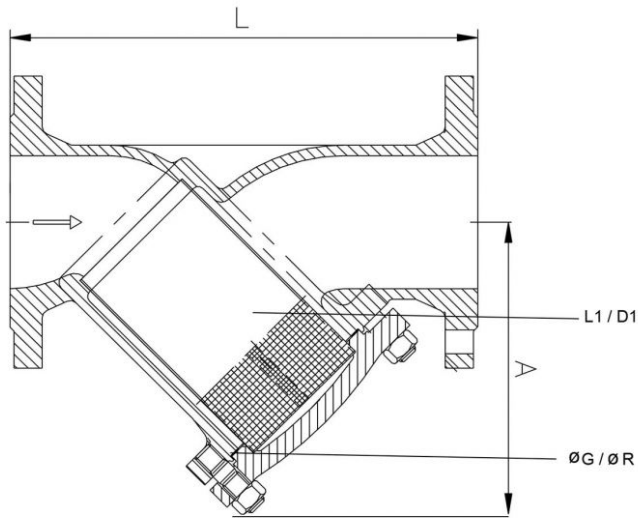

DN	Nominal diameter
L	Face to face dimension (mm)
A	Centre line of pipe to end of cover (mm)
L1	Screen length (mm)
D1	Screen diameter (mm)
Fo	Free screen area standard element (mm)
KVS1	KVS-Value standardscreen (m <sup>3</sup> /h)
KVS2	KVS-Value fine screen (m <sup>3</sup> /h)
Zet1	Zeta-Value standardscreen
Zet2	Zeta-Value fine screen
ø G	Outer-diameter coverflange gasket (mm)
ø R	Inner-diameter coverflange gasket (mm)
P	Thickness coverflange gasket (mm)
D	Coverflange size
B	Distance required to remove screen (mm)